

EDDIE Z'S / 3 DAY BLINDS

The image shows the exterior of an EddieZ's store. The main building has a red sign that reads "EddieZ's" in a large, white, cursive font, with "A 3 DAY BLINDS COMPANY" in smaller white capital letters below it. The storefront consists of large glass windows and doors, reflecting the sky and surrounding area. To the left of the main entrance is a white garage door. To the right, there is a covered walkway leading to another part of the building. In the background, another building with a red and white facade and a large "K&G" logo is visible. The sky is blue with scattered white clouds. The foreground is a paved parking lot.

C-1	COVER SHEET DRAWING INDEX
SL	SYMBOLS LEGEND
AB-1	FLOOR PLAN
AB-2	REFLECTED CEILING

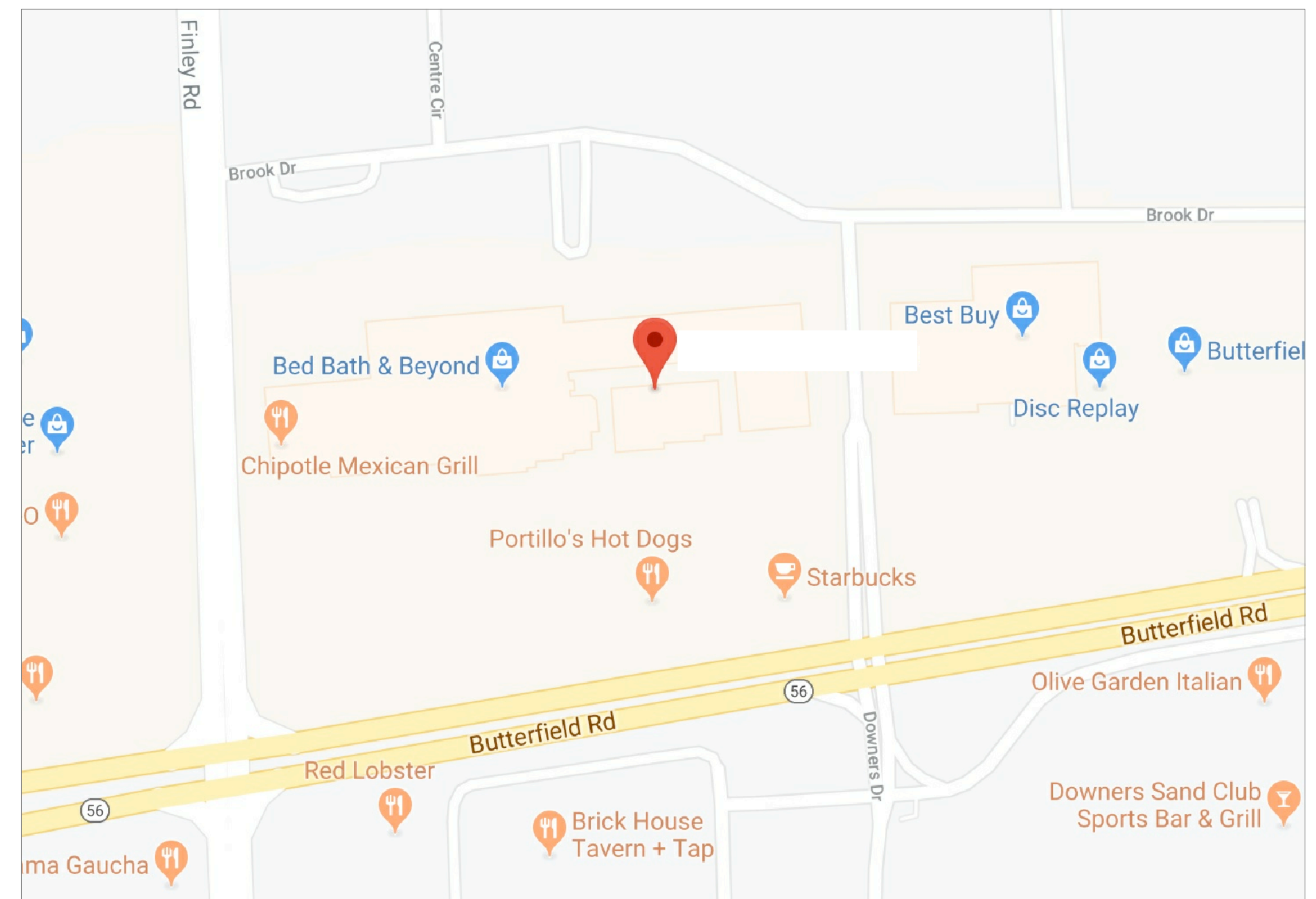

AREA DATA

SHOWROOM	2166 S.F. ±
----------	-------------

ARCHITECTURAL AS BUILT DOWNERS GROVER IL

C-1

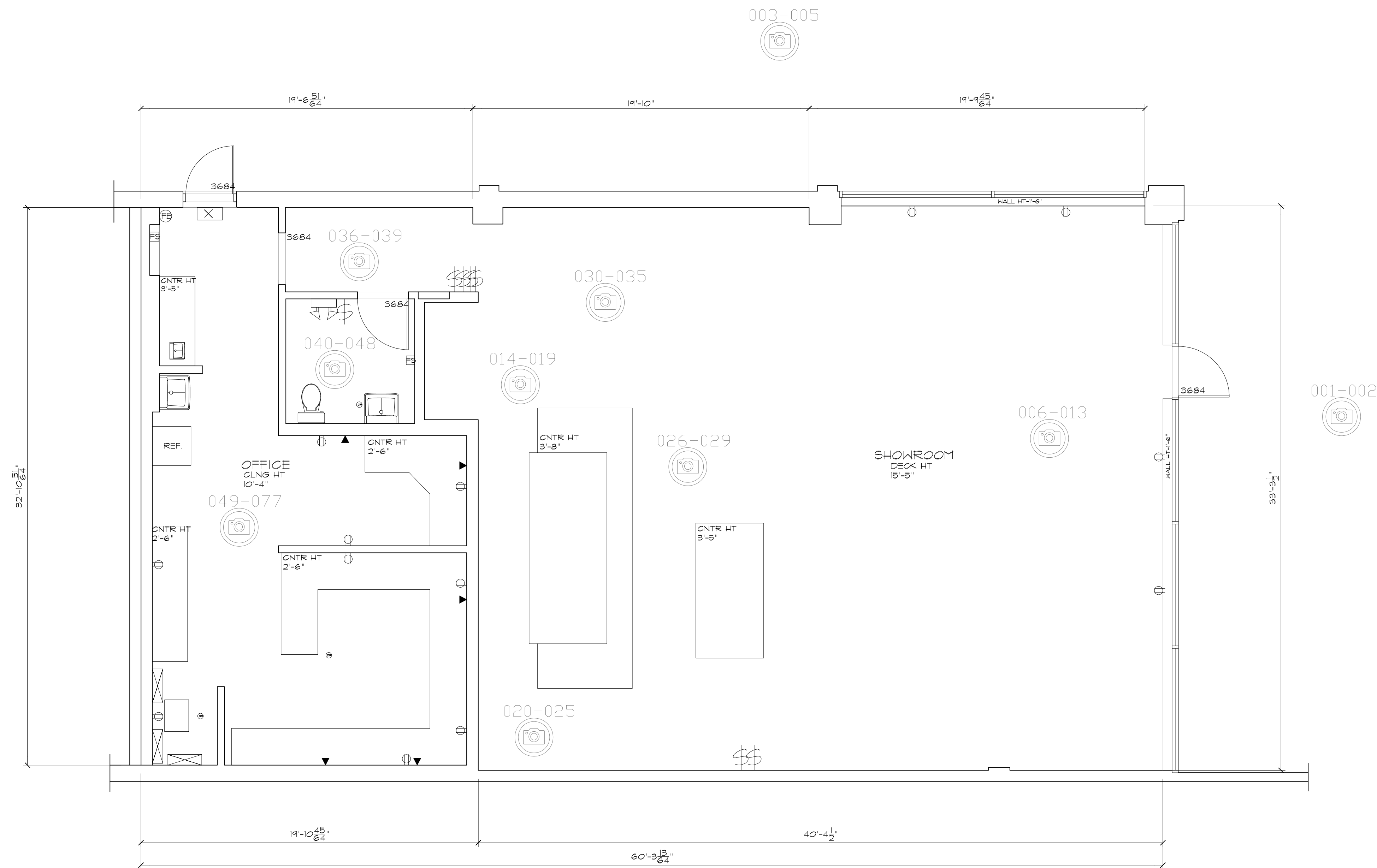

FLOOR PLAN 1/4"=1'-0"

AS BUILT
PROFESSIONALS
www.asbuiltprofessionals.com
A DIVISION OF:

AEC
CONSULTANTS INC
844.272.8458
844 AS BUILT

© 2019 AEC CONSULTANTS INC

ARCHITECTURAL AS BUILT
DOWNERS GROVER IL

01	100% SUBMISSION	SEE COVER SHEET
NO.	ISSUES REVISIONS	DATE
		SHEET TITLE
HL	PROJECT MANAGER	
HL	PROJECT DIRECTOR	
012317-1	PROJECT NUMBER	
1/4"=1'-0"	SCALE	
CL	DRAWN BY	
		SHEET NUMBER

AB-1



O1	100% SUBMISSION	SEE COVER SHEET
NO.	ISSUES REVISIONS	DATE
		SHEET TITLE
H/L		PROJECT MANAGER
H/L		PROJECT DIRECTOR
012317-1		PROJECT NUMBER
1/4"=1'-0"		SCALE
CL		DRAWN BY
		SHEET NUMBER

AB-2